

PROSPECT HILL PARK
CITY OF WALTHAM
MASSACHUSETTS

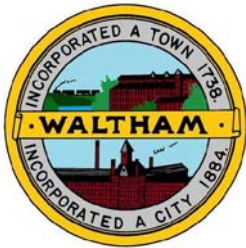

Park Rules

The park is open year round to the general public from dawn to dusk.

Motor vehicle access from April to October.

The speed limit is 10 miles per hour.

Motor vehicles are restricted to paved roadways and designated parking areas.

Motorized recreation vehicles such as snowmobiles, dirt bikes and all terrain vehicles are prohibited on park property.

The City's leash law is enforced in all parks. You must clean up after your pets.

No alcohol allowed on the premises.

No open fires are allowed. Charcoal grills are available for cooking.

Picnic areas must be left clean and neat. trash receptacles are provided for low volume picnic waste only. Large groups are responsible for removing their own trash.

The dumping of household or commercial refuse on park property is prohibited.

The harming, trapping, killing or removal of any bird or animal is prohibited.

The cutting, picking, up-rooting, breaking, altering, or removing of any tree, flower, shrub or living vegetation is prohibited.

Paint ball is prohibited in the park.

No person shall in any manner deface, damage, or remove any item of park property, equipment, building or fixture.

No person shall behave in a manner that will interfere with the use of and enjoyment of park features by the public.

Date: 8/30/2021

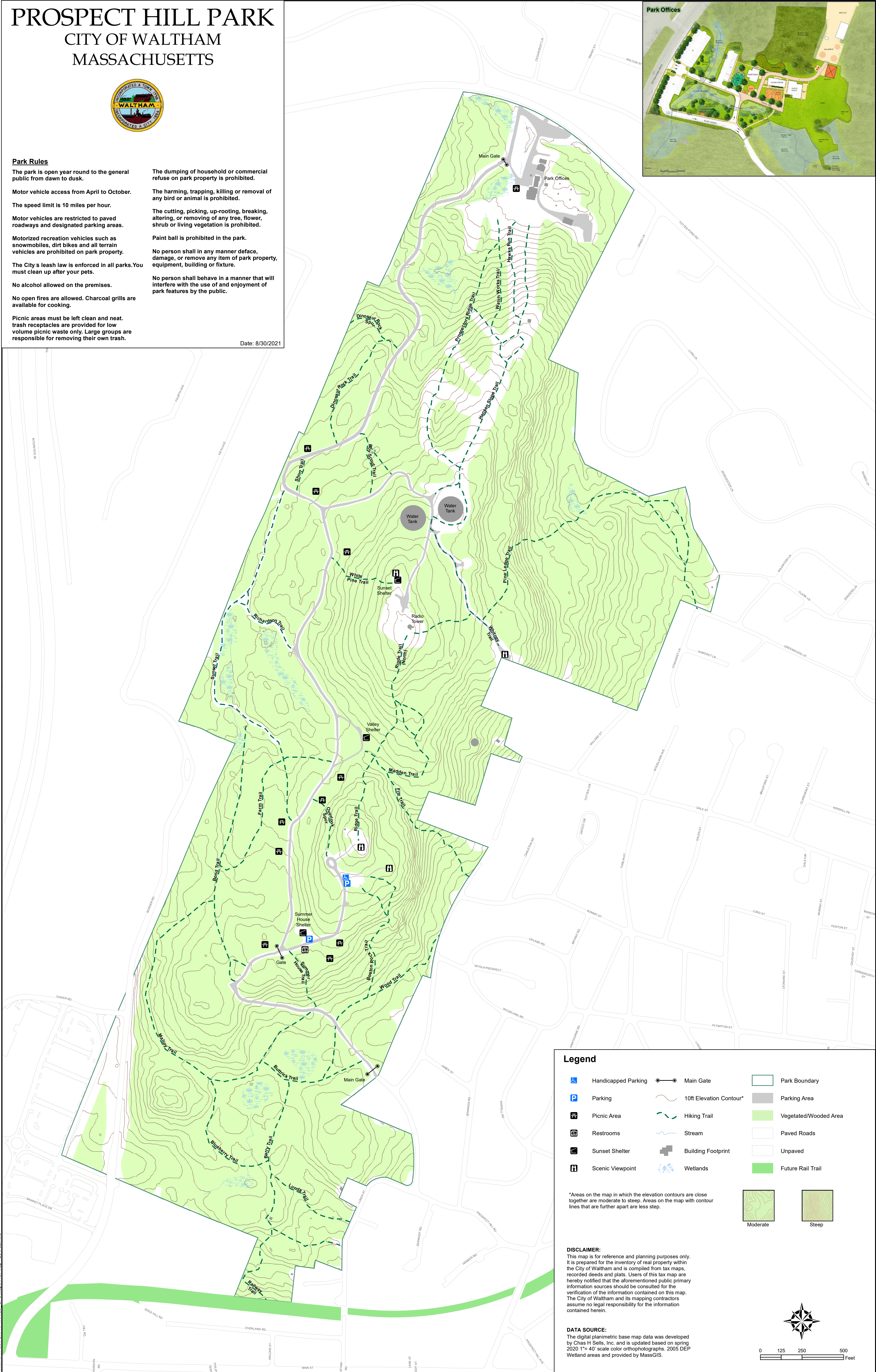

Legend

- | | | | | | |
|--|---------------------|--|-------------------------|--|-----------------------|
| | Handicapped Parking | | Main Gate | | Park Boundary |
| | Parking | | 10ft Elevation Contour* | | Parking Area |
| | Picnic Area | | Hiking Trail | | Vegetated/Wooded Area |
| | Restrooms | | Stream | | Paved Roads |
| | Sunset Shelter | | Building Footprint | | Unpaved |
| | Scenic Viewpoint | | Wetlands | | Future Rail Trail |

*Areas on the map in which the elevation contours are close together are moderate to steep. Areas on the map with contour lines that are further apart are less steep.

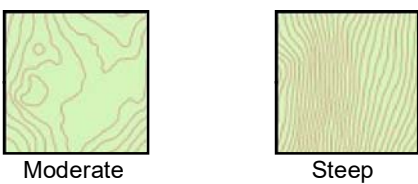

DISCLAIMER:
This map is for reference and planning purposes only. It is prepared for the inventory of real property within the City of Waltham and is compiled from tax maps, recorded deeds and plats. Users of this tax map are hereby notified that the aforementioned public primary information sources should be consulted for the verification of the information contained on this map. The City of Waltham and its mapping contractors assume no legal responsibility for the information contained herein.

DATA SOURCE:
The digital planimetric base map data was developed by Chas H Sells, Inc. and is updated based on spring 2020 1"= 40' scale color orthophotographs. 2005 DEP Wetland areas and provided by MassGIS.

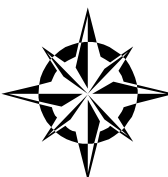

0 125 250 500
Feet